

Geberit Type 380 fill valve, lateral water supply connection, 3/8", nipple made of brass

■ GEBERIT

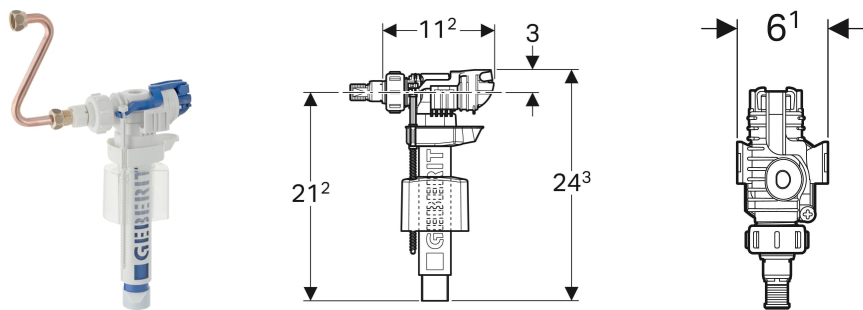

APPLICATION PURPOSES

- For Geberit concealed cisterns
- For greywater (rainwater) with pH value 6.0–9.5, if a filter system is used
- For potable water

CHARACTERISTICS

- Adjustable filling height

- Threaded nipple made of brass
- Water supply connection on the left/right
- Low-noise in accordance with tap group I (DIN 4109)

TECHNICAL DATA

| | |
|---------------------|------------|
| Flow pressure | 0.1–10 bar |
| Storage temperature | ≤ 40 °C |
| Flow rate at 3 bar | 0.19 l/s |

SCOPE OF DELIVERY

- Adapter for nipple, for Type 350 fill valve
- Cone screw fitting
- Connection pipe made of copper

| Art. no. | B cm | H cm | T cm |
|--------------|---------|---------|---------|
| 240.705.00.1 | 6.1 | 24.3 | 11.2 |
| Phasing out | | | |